

Ultra & Heritage Series Sterling Double Hung Products

To the Installer: Leave this instruction and safety information sheet with the current owner and/or future occupants. This document is also available at www.kolbewindows.com.

Introduction: These operating instructions are for Kolbe's Ultra & Heritage Series Sterling Double Hung windows. When installed and used as instructed, this window opening control device complies with ASTM F2090-13 requirements.

Note: Numbers in parentheses represent approximate metric equivalents in millimeters.

After completing installation, verify that the window opening control device operates properly by following the steps below.

WARNING

WARNING: FALL HAZARD – Young children may be at risk of falling if the window opening control device is not installed correctly. When correctly engaged, the lowest part of the window opening should not have any gap that would allow a rigid object with a diameter of 4 inches (102 mm) to pass through.

⚠ CAUTION

Do not remove a window opening control device at any time, improper application may result in the device being ineffective in preventing falls through an open window.

⚠ CAUTION

Proper Eye and Hearing Protection must always be worn when installing, removing or performing adjustments to Kolbe window and door products.

⚠ CAUTION

Contact your local building code department for specific applicable codes prior to installing units with factory installed window opening control devices.

Operation of the Window Opening Control Device

Opening the Bottom Sash and Disengaging the Window Opening Control Device:

1. Unlock the window and lift the sash until it reaches the opening limit (**Fig. 1**).
2. Push both devices into the frame. They will snap down behind the bottom sash (**Fig. 2**).
3. Slide the sash up past the devices.

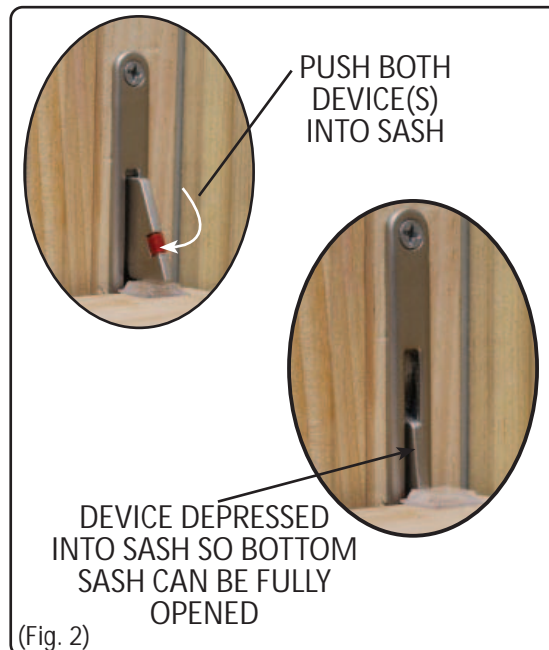
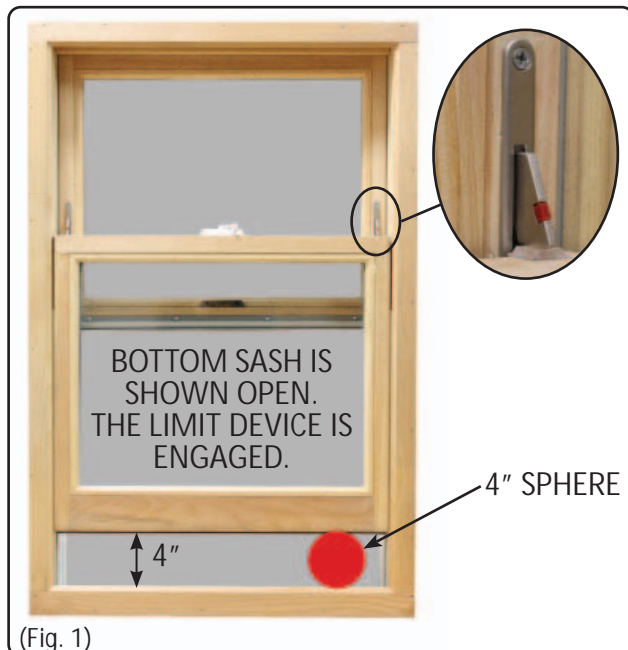

Closing the Window and Re-Setting the Window Opening Control Device:

1. Lower the sash to the closed position. The device will automatically re-set once the sash is below the device.
2. Confirm that the device has re-set by opening the window until it stops at the device limit.
3. Return the window to the closed position and lock it.