

⚠ WARNING

Proper Eye and Hearing Protection must always be worn when installing, removing or performing adjustments to Kolbe window & door products.

READ THESE INSTRUCTIONS COMPLETELY BEFORE ATTEMPTING ANY INSTALLATION!

TOOLS REQUIRED BEFORE STARTING

- Safety glasses/goggles
- Tape Measure
- Rubber Mallet
- Phillips screwdriver
- Drill & 9/64" Drill bit
- Clamp

Parts Needed: Quantities ()

- A - Cassette (housing & pull bar) (1)
- B - Side Rails (1 L & 1 R)
- C - Wood Trim for Housing (1)
- D - Wood Trim for Pull Bar (1)
- E - Wood Trim for Side Rails (2)
- F - Small Pile Opener (1)
- G - #8 x 5/8" Phillips Pan Head screws (10)
- H - #6 x 3/4" Phillips Flat Head screws (4)

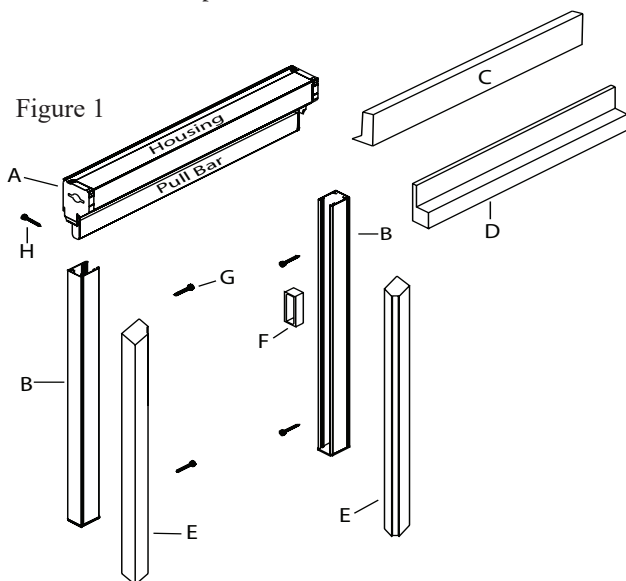

INTRODUCTION

These instructions are for installing a retractable screen to the interior of your Kolbe product. A minimum jamb depth of 5-3/4" is needed for Heritage (wood exterior) Casement units and for Ultra (extruded aluminum exterior) Casement units a 5-3/16" jamb depth is needed. A minimum jamb depth of 6-9/16" is needed for Sterling Double Hung units.

STEP #1: PRELIMINARY PREPARATION

Lay out and identify all parts shown in figure 1 before installation.

STEP #2: PREPARE PARTS FOR INSTALLATION

Check the spring tension by holding the cassette (A) in your hand and pulling down on the pull bar with the other hand. If you don't like the amount of tension, you may adjust it to your personal preference.

To adjust the spring tension hold the cassette so the flat side of the housing faces towards you. The spring is connected to the right side housing end cap. Gently pry the right side housing end cap out about 2". Holding the end cap **tightly** unwind the spring in a counter-clockwise motion until the spring is completely unwound.

⚠ CAUTION

Be sure to firmly grip the end cap and unwind spring. The spring is loaded and may cause injury if not properly secured while unwinding.

See **fig. 2**. To reset the spring tension, turn the spring in a clockwise winding motion. See the chart below for the correct amount of turns. The chart is only a guideline, you may set the screen tightness to your personal preference.

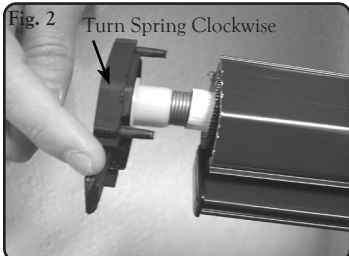

Housing Length	Spring Tension
16 - 20"	4-8 Turns
24 - 26"	8-14 Turns
30 - 36"	14-20 Turns
40 - 48"	20-26 Turns
60"	26-32 Turns

ATTACH WOOD TRIM TO PULL BAR:

See **fig. 3, 4 & 5**. To attach the wood trim (D) to the pull bar (A), place the wood trim on the interior (flat side) of the pull bar so it is flush on the bottom and centered between the end caps. Use a clamp to hold it in place. Drill a 9/64" (4mm) diameter lead hole 2" in from each end of the pull bar and every 8" between. Use #6 x 3/4" black painted flat head screws (H) to attach the wood trim to the pull bar. Screw from the exterior to the interior. Tighten the screws until the head of the screw just hits the exterior of the pull bar. Overtightening screws will distort the pull bar.

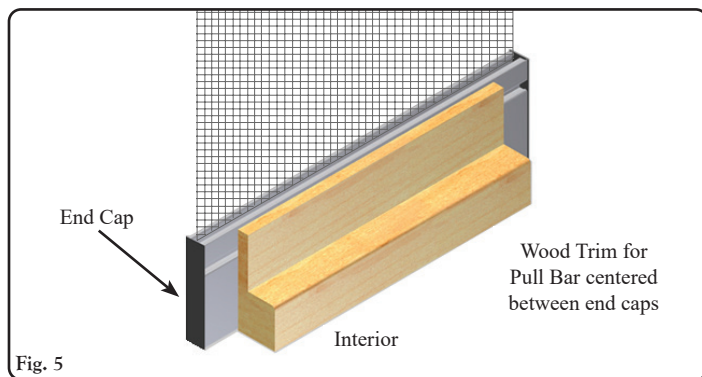
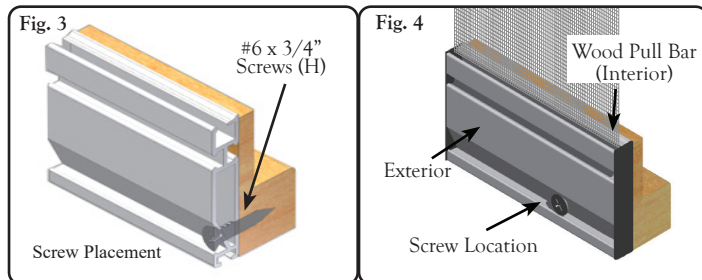

STEP #3: INSTALL SCREEN IN WINDOW

See **fig. 6**, position the flat side of the cassette so it faces the exterior of the window and slide it into position at the head (top) of the window (the side rails will secure the housing in place once they have been installed).



The flat side of the side rails should face the exterior, and the side with the groove should face the interior. See **fig. 7**, take the left side rail and slide the top of it onto the tongue of the cassette housing end cap. See **fig. 8**, gently slide the bottom into place. Repeat for the right side.

⚠ WARNING

When a unit is prep for stool, the side rails (both the side rail and wood part) may need to be cut to fit.

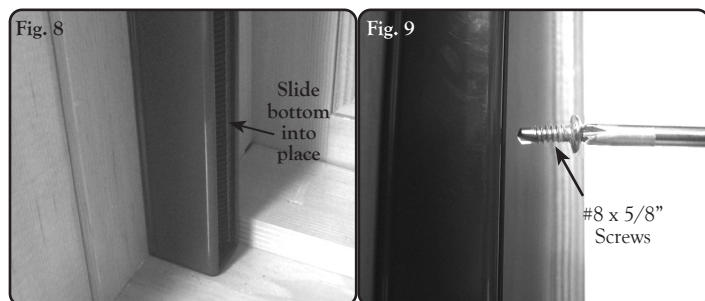

A small pile opener is included in the parts kit. Locate where the pre-drilled holes are in each side rail and place the small pile opener centered over a hole for easy access to the screw hole. See **fig. 9**, secure the side rail in place using the supplied #8 x 5/8" screws (G). Repeat for each screw hole on each side rail. The small pile opener is only used to separate the pile while applying the screws. Take out when all screws are installed.

STEP #4: ATTACH WOOD TRIM

Take the wood trim for housing (C) and peel the backing off the tape. Place the wood trim against the top extension jamb and firmly press onto the housing. Make sure it is pushed down tight. Take the wood trim for the side rail (E) and peel the backing off the tape. Place the wood trim against the side extension jamb and press firmly onto the side rails (B). Repeat for other side rail. Be sure to place the wood sides so the beveled edges face the center of the window.

STEP #5: OPERATION OF SCREEN

Pull down on the pull bar and fully extend the screen to engage the latching mechanism. To retract the screen, gently push the

pull bar towards the exterior of the window near the center of the pull bar to disengage the latching mechanism and retract the roller screen.

COMPONENT PART REPLACEMENT

The diagram below is to help you identify component parts if you need to re-order any parts from Kolbe for your Retractable Screen. Please specify window size when re-ordering parts.

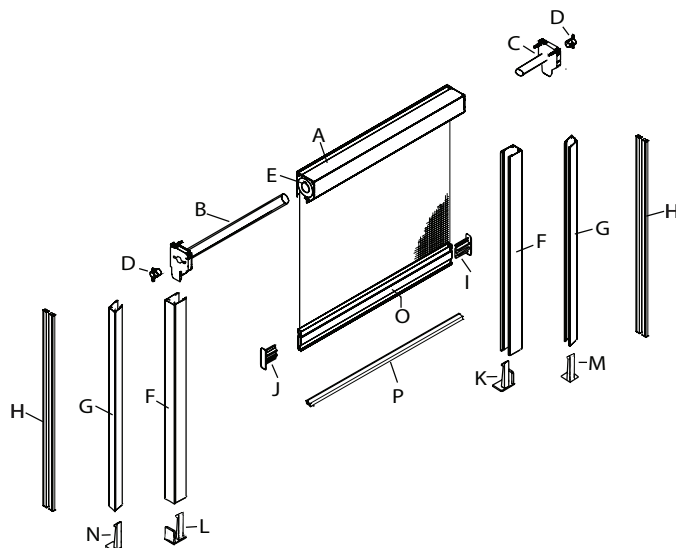

- A - Screen Housing
- B - Spring Assembly
 - Frame width up to 20" = 8" Spring
 - Frame width 21" - 28" = 11.5" Spring
 - Frame width 29" and up = 16" Spring
- C - Right Endcap Assembly
- D - Plug for Endcap
- E - Screen Mesh on Tube
 - Frame height up to 65" = 66" Screen Mesh
 - Frame height 66" - 90" = 92" Screen Mesh
- F - Side Rails 30mm (Csmt)
- G - Side Rails 22mm (DH)
- H - Side Rail Wind Pile
- I - Plug Endcap Right for Pull Bar
- J - Plug Endcap Left for Pull Bar
- K - Internal Latch Right for Guide 30x22mm (Csmt)
- L - Internal Latch Left for Guide 30x22mm (Csmt)
- M - Internal Latch Right for Guide 22x22mm (DH)
- N - Internal Latch left for Guide 22x22mm (DH)
- O - Pull Bar
- P - Pull Bar Pile
- Q - Bag of Screws

Contact your Kolbe window & door supplier or visit us at www.kolbewindows.com for further information.

THANK YOU
FOR PURCHASING KOLBE PRODUCTS.

Kolbe & Kolbe Millwork Co., Inc. reserves the right to change specifications without notice.