

## Ultra & Heritage Series Sterling Double Hung products

**INSTALLER:** Leave this instruction & safety information sheet for the current owner and/or future occupant(s).

This document is also available at [www.kolbewindows.com](http://www.kolbewindows.com)

**INTRODUCTION:** This operating instruction is intended for use with Kolbe's Ultra & Heritage Series Sterling Double Hung products. When installed and used as directed, this window opening control device meets ASTM F2090-13 requirements.

**NOTE:** Numbers listed in parentheses ( ) are metric equivalents in millimeters rounded to the nearest whole number.

### ⚠ CAUTION

Contact your local building code department prior to installing units with factory installed window opening control devices to ensure all applicable building and fire codes are met. DO NOT remove any window opening control device, improper application may result in the device not functioning properly and thus being ineffective in preventing falls through an open window.

### ⚠ WARNING

**POSSIBLE FALL HAZARD:** Young children may fall out of the window if the window opening control device is not installed correctly. When properly engaged, no space shall exist at the lowest opening portion of the window opening that would permit the passage of a rigid sphere measuring 4" (102) in diameter.

When installation of unit is complete, check window opening control device for proper operation. See steps below for operation of window opening control device.

## Operation of Window Opening Control Device

*Opening bottom sash and disengaging window opening control device:*

1. Unlock window and lift sash to open limit. See figure 1.
2. Push both devices into unit. They will snap downward behind the bottom sash. See figure 2.
3. Slide the sash up past the device.

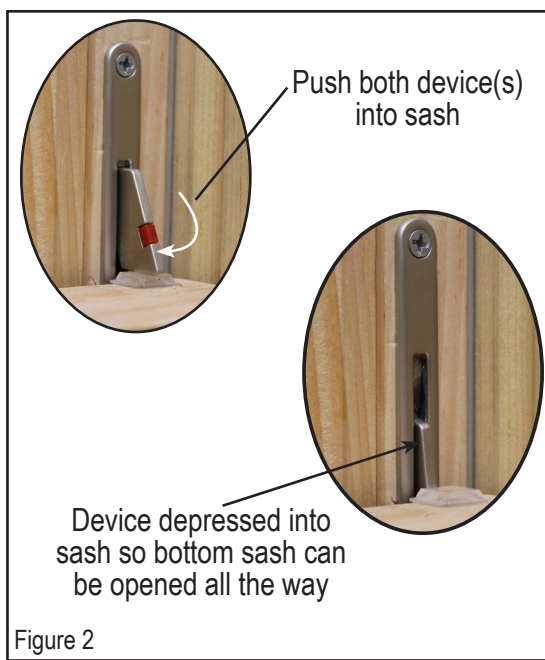
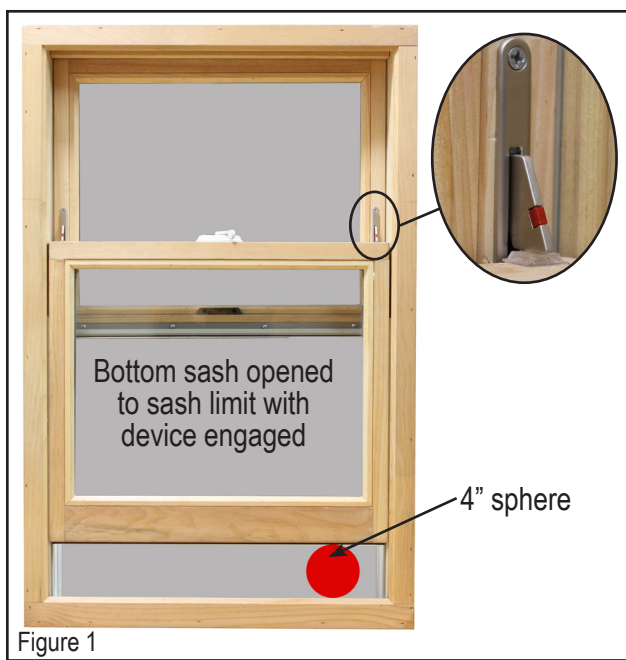

*Closing window and re-setting window opening control device:*

1. Move sash down to closed position. The device will automatically re-set once sash is moved below device.
2. Check that the device re-set. To do that, open window until device limits the window from opening.
3. Return window to closed position and lock.