



■ WINDOWS & DOORS ■

STUCCO TRIM  
INSTALLATION & SEALING  
INSTRUCTIONS

READ THESE INSTRUCTIONS COMPLETELY BEFORE  
ATTEMPTING ANY INSTALLATION



Kolbe & Kolbe Millwork, Co., Inc.  
1323 S. 11th Ave. - Wausau, WI 54401 - [www.kolbe-kolbe.com](http://www.kolbe-kolbe.com)

### ⚠ NOTE

Failure to install and maintain our product according to these instructions will void any warranty, written or implied. The installer is responsible for consulting the contractor, structural engineer, architect, or consumer, for proper installation according to local codes and/or ordinances.

### ⚠ WARNING

Proper Eye and Hearing Protection must always be worn when installing, removing or performing adjustments to Kolbe window and door products.

### ⚠ WARNING

Improper use of hand/power tools could result in personal injury and/or product damage. Follow manufacturer's instructions for safe operation of equipment.

### ⚠ NOTE

Before applying sealant or adhesive pads, make sure the area to be sealed is clean, and dry. Use color-matching or transparent sealant.

## INTRODUCTION

These instructions are for preparing, applying and sealing the stucco trim option for Ultra products.

## ITEMS REQUIRED BY INSTALLER

- Head and Jamb trim (B8329) fabricated per spec.
- Sillnosing (B8330) fabricated per spec.
- Caulk gun
- Phillips head screwdriver
- Foam Corner gaskets
- Isopropyl alcohol
- Closed cell foam backer rod in 3/4" (19mm) diameter
- #8 x 3/4" (19mm) P PH SMS TEK screws
- #8 x 1 1/2" (38mm) P FH 18-8 SMS screws
- Sillnose end caps
- Silicone sealant
- Power drill/driver
- Putty knife
- Disposable wipes

## PRELIMINARY PREPARATION

### PREPARE FRAME KERF

Notch the sill-end corners to allow clearance for the insert leg of the stucco trim. See fig. 1.

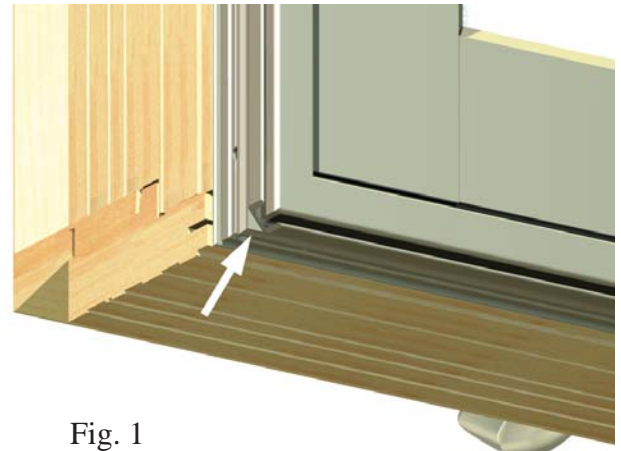

Fig. 1

## APPLYING THE SILLNOSE

### SEALANT APPLICATION

Apply a bead of sealant to the sillnose in the location shown in fig. 2. Make sure the sealant extends the full width of the sillnosing along the entire length on the insert leg. The sealant bead should be about 3/16" diameter.

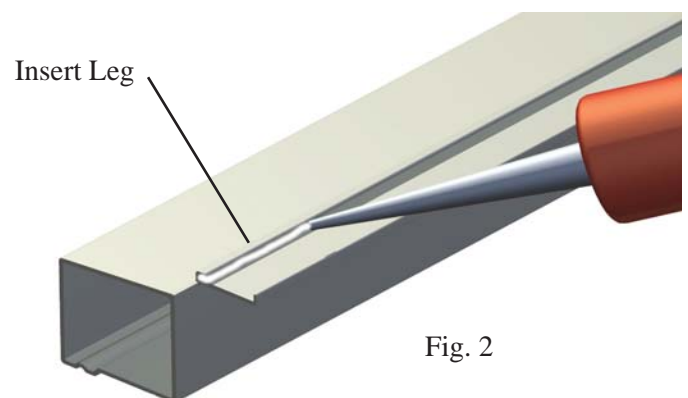

Fig. 2

## APPLYING THE SILLNOSE TO FRAME

Apply the sillnose on the unit sill by engaging the insert leg into the frame kerf. You will have to begin the engagement by tilting the sillnose slightly up and then rolling it down into position. See fig. 3.

### ⚠ NOTE

Immediately clean up any sealant that may squeeze out of the joint on the exterior side (visible to customer) with isopropyl alcohol and a disposable wipe.



Fig. 3

### SECURING THE SILLNOSE TO FRAME

Secure the sillnose to the frame cladding by applying #8 x 3/4" (19mm) P PH SMS TEK screws as shown in Fig. 4. Screws should be placed 3 inches in from each end and spaced 10 to 12 inches on center along the sillnose. See Fig. 4.

#### NOTE

Make sure the sillnose is perfectly centered on the frame (left to right) prior to applying screws.



Fig 4.

### APPLYING THE SIDE JAMB TRIM

#### PREPARE THE SIDE JAMB TRIM

Ready the side jamb trim by peeling back the release film from the foam sealing tape on EACH END of the trim. Pull just enough release film to allow you to fold it over at a 90° angle and crease it so about 1/2" will stick out from the trim when applied. This will allow you to position and secure the trim and then pull the remainder of the release film afterward. See fig. 5.

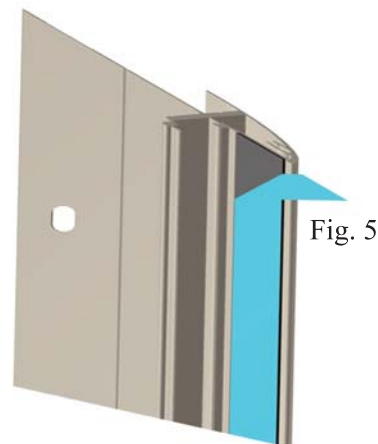

Fig. 5

#### INSERT FOAM BACKER ROD

Insert about a 1" piece of 3/4" diameter foam backer rod into the head end only of each left and right side jamb trim profile. Push the backer rod into the profile until it is just past the second hole on the mitered end of the side jamb trim piece. See fig. 6



Fig. 6

#### APPLY THE SIDE JAMB TRIM

Apply the side jamb trim to the frame kerf by inserting the trim leg into the kerf. Make sure that enough release film is sticking out so you can remove it after trim is applied and corners are secured. Opposite side jamb installation is the same. See Fig. 7.



Fig. 7

**NOTE**

Do not pull the remainder of the release film yet.

**APPLYING THE HEAD TRIM**

**PREPARE THE HEAD JAMB TRIM**

Ready the head jamb trim by peeling back the release film from the foam sealing tape on EACH END of the trim as shown in fig. 8. Pull just enough release film to allow you to fold it over at a 90° angle and crease it so about 1/2" will stick out from the trim when applied. This will allow you to position and secure the trim and then pull the remainder of the release film afterward.

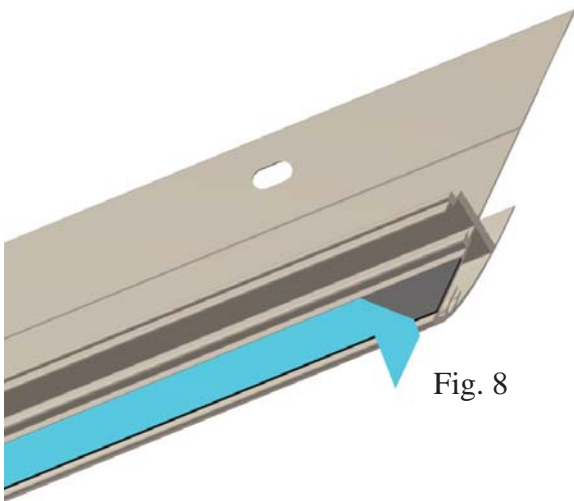

Fig. 8

**INSERT FOAM BACKER ROD**

Insert about a 1" piece of 3/4" dia foam backer rod into each end of the head trim. Push the rod into the profile until it is just past the second hole on each end of the trim piece. See fig. 9.

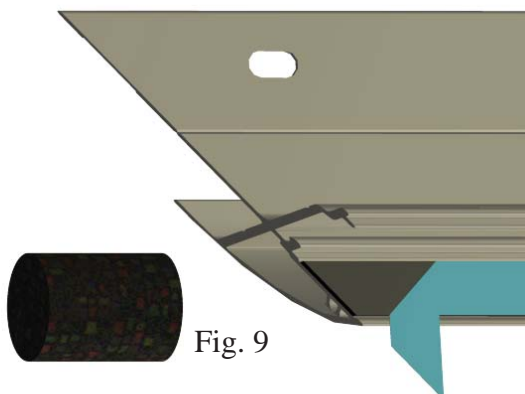

Fig. 9

**APPLY HEAD TRIM**

Apply the head trim to the frame kerf by inserting the trim leg into the kerf. Make sure that enough release film is sticking out so you can remove it after head trim is applied. See Fig. 10.

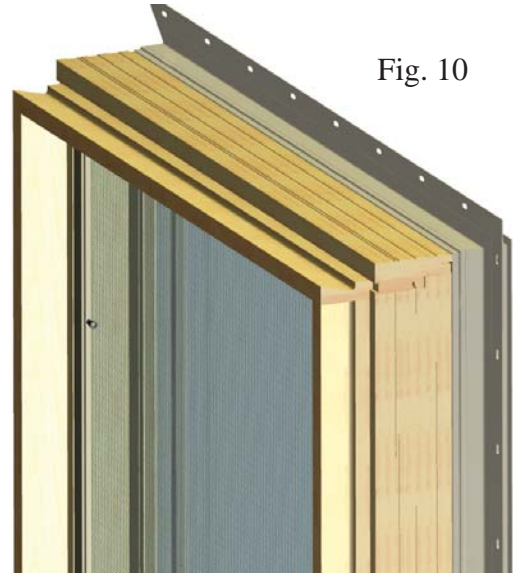

Fig. 10

**FASTENING MITERED CORNERS (HEAD)**

**FASTENING THE HEAD MITER**

Fasten the mitered corners by screwing through the side jambs using #8 x 1 1/2" (38mm) P FH 18-8 SMS screws. See Fig. 11.

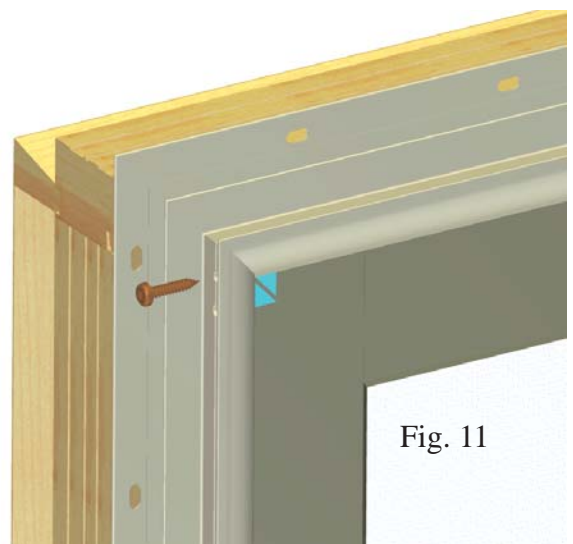

Fig. 11

**NOTE**

Ensure all surfaces of the miter joint are aligned before fastening together. Screw should engage the screw boss in the opposing trim piece. Do not overtighten.

## PULLING THE RELEASE FILM

LAST CHANCE TO MAKE SURE EVERYTHING LOOKS RIGHT!

When you are sure everything is seated correctly and looks aligned, slowly pull all the release films from around the trim assembly as shown in fig. 12. If one should break before it is fully removed, grasp the other "tail" on the opposite end of the trim and pull the remainder free of the adhesive.



Fig. 12

### ⚠ CAUTION

Once the release film is pulled, no further adjustment of the trim will be possible. The trim position should be considered permanent

## SECURING THE TRIM PEICES TO THE FRAME

### SECURE HEAD AND SIDE JAMB TRIM

Secure the head and side jamb trim to the frame cladding by applying #8 x 3/4" (19mm) P PH SMS TEK screws as shown in Fig. 13. Screws should be placed 3 inches in from each end and spaced 10 to 12 inches on center along the trim. See fig 13.



Fig. 13

## SEALING THE HEAD MITER JOINT

### INTERNALLY SEALING THE HEAD MITER JOINT

Insert the nozzle of caulk gun into top fill hole and fill the joint until sealant comes out of the side fill hole. See Fig. 14

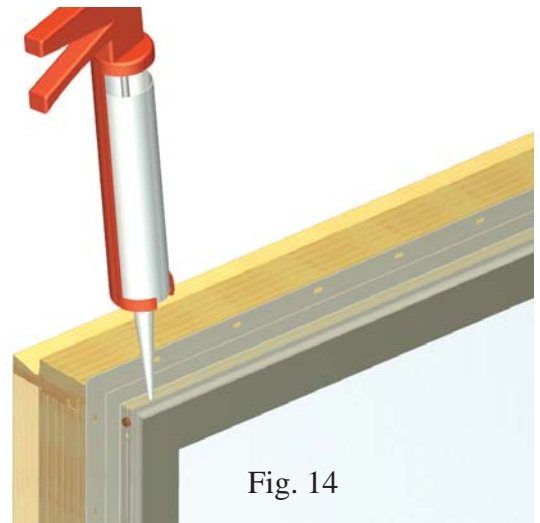

Fig. 14



## APPLYING THE SILLNOSE END CAPS

### INSTALL END CAPS

Insert end caps by applying a small amount of sealant to the inside edge of the cap and inserting it into the sillnosing as shown in fig. 15. Do this on each side of sillnose.

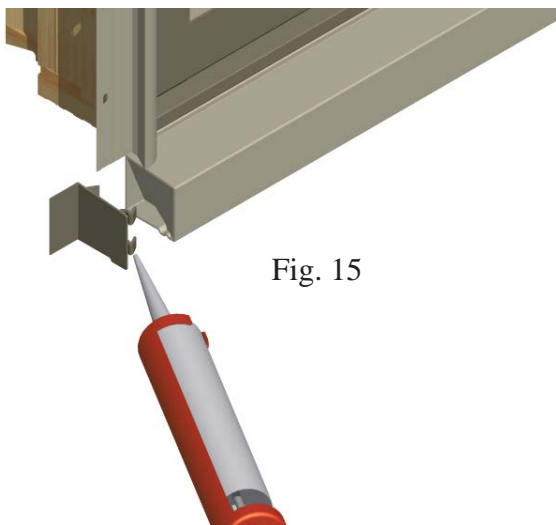

Fig. 15

### SEAL SIDE JAMB TRIM TO SILLNOSE

Apply a small bead of sealant to the inside edge of the side jamb trim to sillnose joint as shown in Fig. 16.

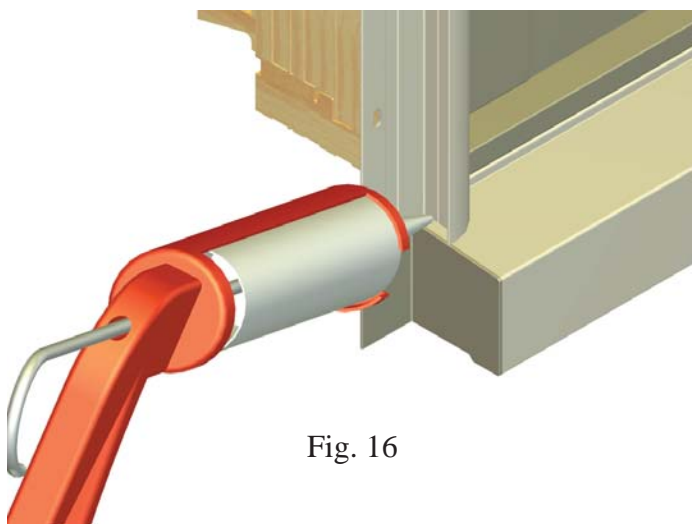

Fig. 16

## APPLY FOAM GASKETS TO TRIM JOINTS

### APPLY FOAM GASKETS

Complete the trim installation by applying foam gaskets to the trim joints as shown in figs. 17 and 18.

Fig. 17

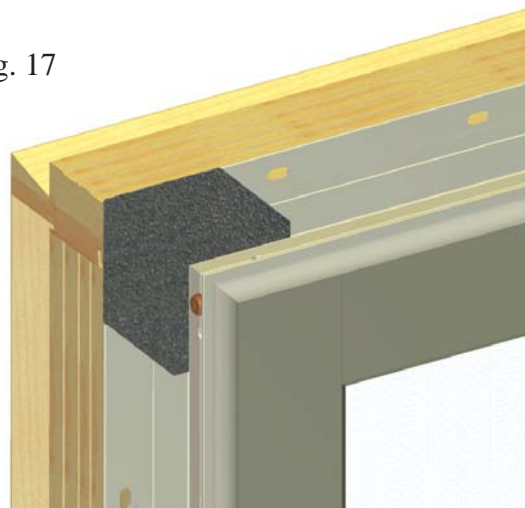

Fig. 18

**SPECIAL INSTRUCTIONS FOR STUCCO TRIM  
APPLIED TO DOORS**

**⚠ NOTE**

This step is required for stucco trim applied to doors only. All other application and sealing steps are the same except for this side jamb trim to sill joint on door applications.

**SEAL SIDE JAMB TRIM TO SILL (doors only)**

Apply a small bead (1/8" dia.) of sealant to the inside edge of the side jamb trim to sillnose joint as shown highlighted in red in Fig. 19. Finish off the bead with tool or finger to leave a nice looking fillet.



Fig. 19