

Ultra & VistaLuxe Complementary Series 916 HP Sliding Window

Important Safety Information

Installer: Leave this Safety Information sheet for the current owner and/or future occupant(s).

This document is also available at www.kolbewindows.com

NOTE: This safety information is for Kolbe's Ultra & VistaLuxe Complementary Series 916 HP Sliding window products. When installed and used as directed, this window opening control device meets ASTM F2090-17 requirements. Follow manufacturer's instructions carefully. Failure to do so may result in accidental window falls.

NOTE: Numbers listed in parentheses () are metric equivalents in millimeters rounded to the nearest whole number.

⚠ CAUTION

Contact your local building code department for specific applicable codes prior to installing units with factory installed window opening control devices.

⚠ CAUTION

Do not remove a window opening control device at any time, improper application may result in the device being ineffective in preventing falls through an open window.

⚠ WARNING

IMPORTANT

- The window opening control device must be installed in such a manner that after it is installed and engaged, no space shall exist at the lowest opening portion of the window opening that would permit the passage of a rigid sphere measuring 4" (102) in diameter. See figure 1.
- Failure to follow these instructions may result in the window opening control device's being ineffective in controlling the window opening.
- Once a month check window opening control device for proper operation. Ensure the device is engaged and prevents the inner sash from opening past the device. After verification, close the sash, ensure device is re-engaged and lock window.
- Teach all household members six years old and older how to operate the release mechanism in case of emergency.
- **No window rescue above 75 feet (22,860) or 6th floor.** Do not rely on being rescued from windows above 75 feet. Follow building fire escape plan. Fire rescue ladder may not reach beyond 75 feet.

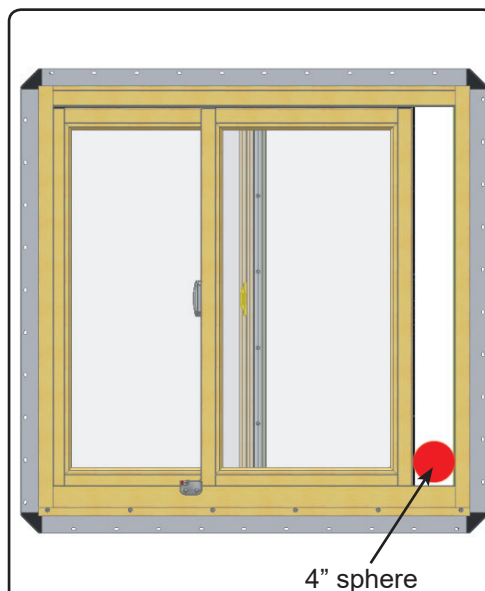

Figure 1

⚠ WARNING

POSSIBLE FALL HAZARD! This window opening control device is designed to help protect against accidental window falls by children five years old and younger. This device is not a substitute for careful supervision of all young children. Keep window opening control devices securely engaged unless needed for use in an emergency.

⚠ WARNING

Blocks escape in fire and emergency unless released. Need to properly operate release mechanism to open the window opening control device (see page 2 for operating instructions). Never apply padlocks or devices that require a key or tool to unlock them to the release mechanism.

When installation of unit is complete, check window opening control device for proper operation. See steps below for operation of window opening control device.

Operation of Window Opening Control Device

Opening sash and disengaging window opening control device:

1. Unlock window and slide sash to open limit. See Figure 1.
2. Move sash away from device slightly. Push in on the red button while also pushing the tab towards the window. This will retract the tongue to allow the sash to move past the device. See figure 2.
3. Once the tongue is retracted into the device, slide the sash past the device to open it fully.

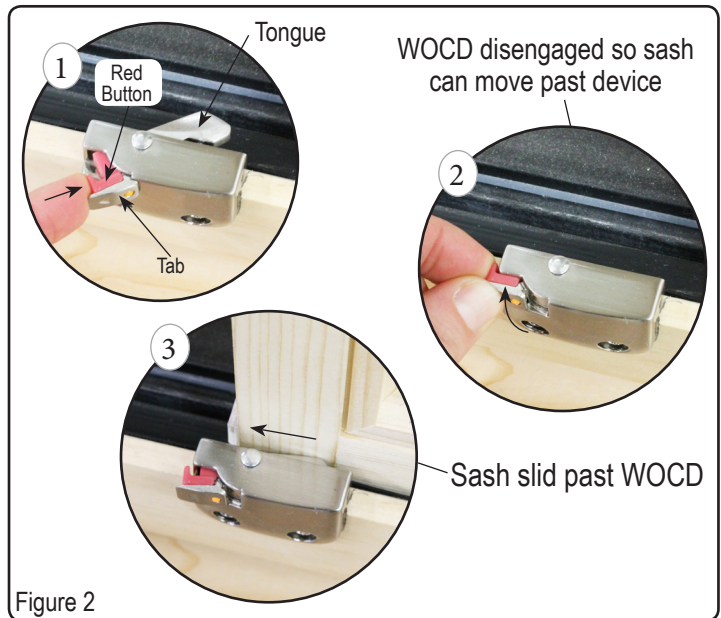
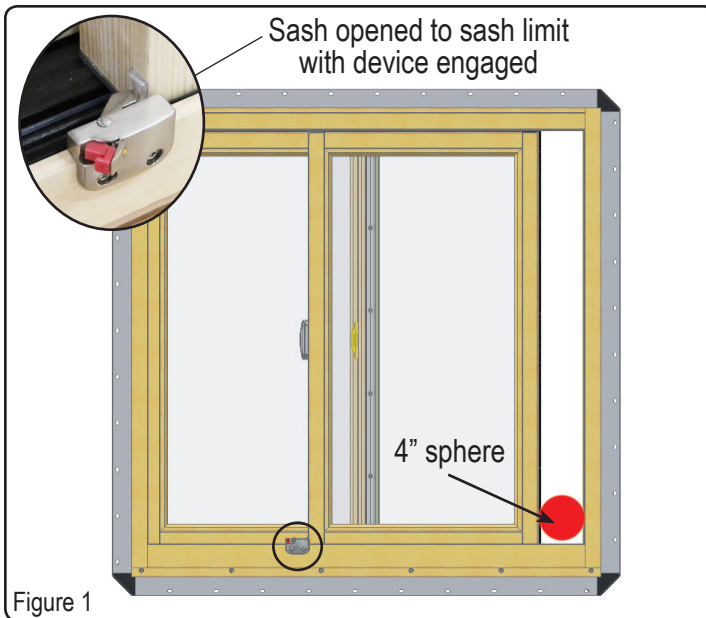

Closing window and re-setting window opening control device:

1. Slide sash to closed position. The device will automatically re-set once sash is moved past device.
2. Check that the device re-set. To do that, open sash until device limits the sash from opening.
3. Return sash to closed position and lock.