

Ultra & VistaLuxe Complementary Series 916 HP Sliding Window

INSTALLER: Leave this instruction & safety information sheet for the current owner and/or future occupant(s).

This document is also available at www.kolbewindows.com

INTRODUCTION: This operating instruction is intended for use with Kolbe's Ultra & VistaLuxe Complementary Series 916 HP Sliding window products. When installed and used as directed, this window opening control device meets ASTM F2090-17 requirements.

NOTE: Numbers listed in parentheses () are metric equivalents in millimeters rounded to the nearest whole number.

⚠ CAUTION

Contact your local building code department prior to installing units with factory installed window opening control devices to ensure all applicable building and fire codes are met. DO NOT remove any window opening control device, improper application may result in the device not functioning properly and thus being ineffective in preventing falls through an open window.

⚠ WARNING

POSSIBLE FALL HAZARD: Young children may fall out of the window if the window opening control device is not installed correctly. When properly engaged, no space shall exist at the lowest opening portion of the window opening that would permit the passage of a rigid sphere measuring 4" (102) in diameter.

When installation of unit is complete, check window opening control device for proper operation. See steps below for operation of window opening control device.

Operation of Window Opening Control Device

Opening sash and disengaging window opening control device:

1. Unlock window and slide sash to open limit. See Figure 1.
2. Move sash away from device slightly. Push in on the red button while also pushing the tab towards the window. This will retract the tongue to allow the sash to move past the device. See Figure 2.
3. Once the tongue is retracted into the device, slide the sash past the device to open it fully.

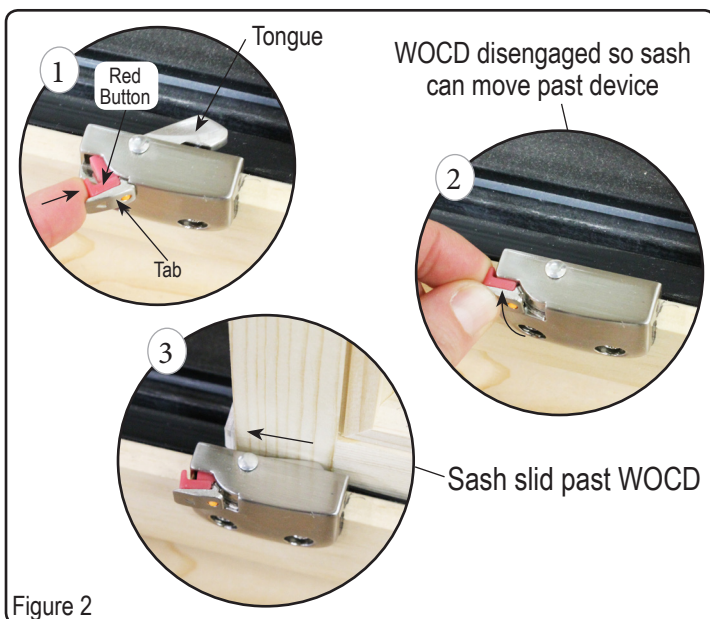
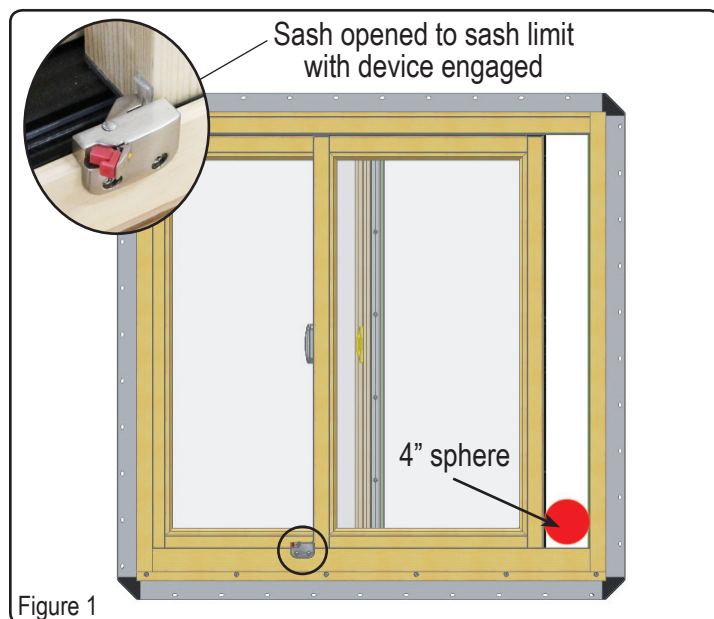

Closing window and re-setting window opening control device:

1. Slide sash to closed position. The device will automatically re-set once sash is moved past device.
2. Check that the device re-set. To do that, open sash until device limits the sash from opening.
3. Return sash to closed position and lock.